



food service tapware

HEAVY DUTY
FIT FOR PURPOSE
PERFORMANCE AND EFFICIENCY

- Pre-Rinse Assemblies
- Hands Free Foot & Knee Operated Tapware

pre-rinse assemblies

Built tough for the demands of busy commercial kitchens where performance and reliability is crucial. Enware's Pre-Rinse Units incorporating Ultra-Rinse provide a wide range of options to suit your kitchen requirements.

Choose from wall or bench mounted configurations, with optional pot fillers for practical use of your sink area.

FEATURES:

- Proven durability in some of Australia's leading restaurants and fast food stores
- Moulded rubber nozzle guard helps reduce the risk of damage from accidental knocks
- Easy to use, ergonomic handle design
- Chisel style spray pattern rapidly removes the food excess for less time spent at the sink
- High water efficiency, reduces water costs and the energy costs for heating the water
- Self-closing trigger spray turns off water when not in use
- Stay open ring keeps spray on for easier prolonged use



WaterMark
AS/NZS 3718 WMKA 1583
SAI Global

Enware Tapware is manufactured to the exacting WaterMark standard AS/NZS3718 and AS4020.

- Dual check valve for backflow prevention
- Premium quality hose, brass and stainless steel to give you maximum strength and dependability
- Modular design can easily be configured to meet your specific needs
- Australian made so parts are always available for an even longer serviceable life.

enware's ultra-rinse pre-rinse spray

Designed and manufactured in Australia to achieve an impressive 6-Star water efficiency rating, the Ultra-Rinse incorporates advanced technology in its easy to use ergonomic design.

The superior high-velocity spray pattern cleans faster and uses less water: with the 6-Star WELS rating reflecting a flow rate of just four litres per minute, significant water-heating energy savings are an added bonus.



water efficiency

POT FILLER WITH MANUAL SHUT-OFF



Pot Filler supplied with a 3 star (8lpm) water efficiency rating.

ULTRA-RINSE PRE-RINSE SPRAY



WELS 6 Star (4lpm) water efficiency rating.

technical information

Minimum-Maximum Working Pressure (AS/NZS 3500)*	50-500kPa
Maximum Static Pressure	1200kPa
Maximum Working Temperature	90°C

For optimum performance it is recommended that the control valves or taps be turned off when not in use overnight or for long periods. Complete pre-rinse assemblies incorporate a dual check valve for backflow prevention. Lever tapware control incorporate quarter turn non-rising jumper valves. *Enware products are to be installed in accordance with AS/NZS3500.

pre-rinse assemblies – options and parts

Enware's modular design and Australian manufacturing means we can easily customise our products to meet specific application requirements. This section is provided as a guide to the options available and our customer service team can help with your special requirements.

G ADJUSTABLE WALL BRACKET

Order Code:
FS070

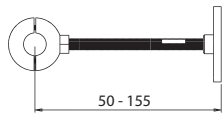

C STAINLESS SPRING

**STAINLESS
STEEL SPRING
RETURN**

Order Code:
FS100
585mm (standard)
FS101
385mm (optional)

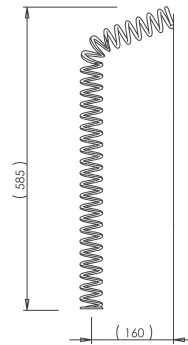

B HEAVY DUTY HOSE

**PRE-RINSE HOSE
WITH SWIVEL
AND 15MM BSP
CONNECTIONS**

Order Code:
FS104 - 400mm
FS106 - 600mm
FS109 - 900mm
FS110 - 1000mm
(Standard)
FS111 - 1100mm
FS115 - 1500mm



D RISER

RISER

Order Code:
FS051 - 100mm (optional)
FS053 - 300mm (standard)
FS056 - 600mm (optional)
FS059 - 900mm (optional)



E POT FILLER ADAPTORS

Order Code:
FS063

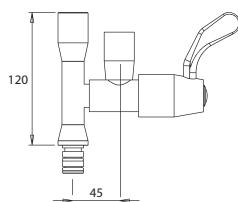

THE LABELS REFER TO THE PARTS AND OPTIONS

Order Code:
FHS141
Pre-rinse unit
with optional
pot filler
shown here

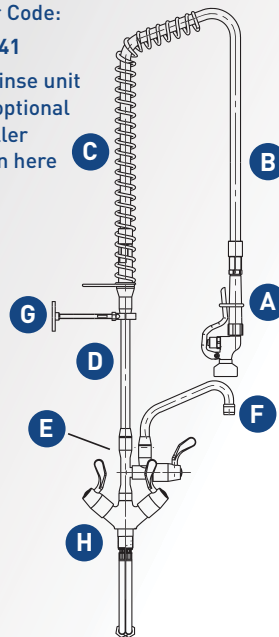

A TRIGGER SPRAYS

**ULTRA-RINSE PRE-RINSE
TRIGGER SPRAY**

Order Code:
FS729

*Rapid rinsing design,
with WELS 6 star rating.
This spray is supplied
standard on Enware
pre-rinse assemblies.*

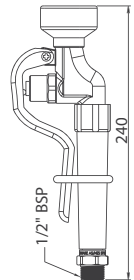

**ULTRA-SPRAY SOFT RINSE
TRIGGER SPRAY**

Order Code:
FS729SS

*This optional spray
is designed for applications
where a gentler spray is
preferred. The head rotates
to alternate between an
aerated spray or a shower
stream pattern.*

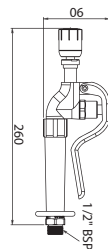

F SPOUT OPTIONS

ANGULAR OUTLET WITH AERATOR

Order Code:

FS180
A 180mm
B 65mm

FS181
A 230mm
B 105mm

FS182
A 300mm
B 125mm

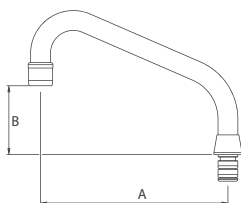

CURVED OUTLET WITH AERATOR

Order Code:

FS184
A 150mm
B 100mm

FS185
A 200mm
B 135mm

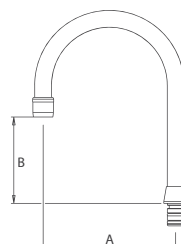

**HEAVY DUTY SWIVEL ARM
WITH 1/2" BSP THREAD**

Order Code:

FS188
A 150mm
B 55mm

FS187
A 300mm
B 75mm

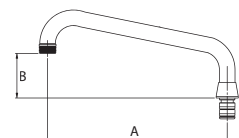

D BASE OPTIONS

Enware's pre-rinse assemblies are the foundation of creating your pre-rinse assembly. Choose from the following standard bases for a bench or wall mounted unit.

HOB MOUNTED

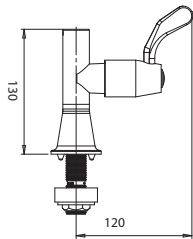

PRE-MIX SINGLE BASE

Order Code:

FS011

For complete assembly refer to order codes: FHS011
FHS111 — with pot filler

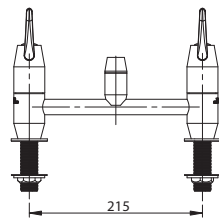

HOB MOUNTED EXPOSED MIXER

Order Code:

FS012

For complete assembly refer to order codes: FHS021
FHS121 — with pot filler

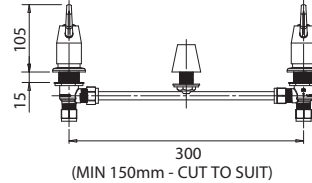

HOB MOUNTED CONCEALED MIXER BASE

Order Code:

FS013

For complete assembly refer to order codes: FHS031
FHS131 — with pot filler

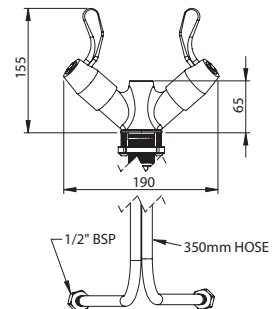

HOB MOUNTED DUAL MIXER

Order Code:

FS015

For complete assembly refer to order codes: FHS041
FHS141 — with pot filler

WALL MOUNTED

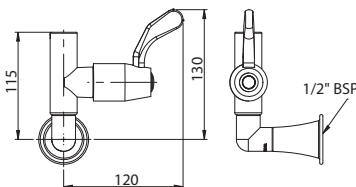

PRE-MIX SINGLE BASE

Order Code:

FS021

For complete assembly refer to order codes: FWS011. FWS111 — with pot filler

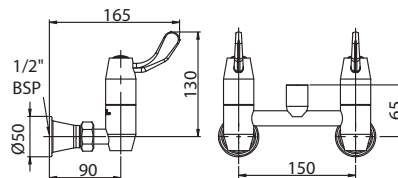

WALL MOUNTED EXPOSED MIXER

Order Code:

FS022

For complete assembly refer to order codes: FWS021. FWS121 — with pot filler

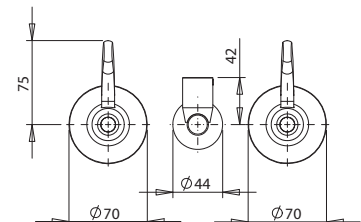

WALL MOUNTED CONCEALED MIXER BASE

Order Code:

FS023

For complete assembly refer to order codes: FWS031
FWS131 — with pot filler

also in this section

HOT AND COLD WASH DOWN HOSE REEL



Order Code:

FS724 - with FS731
Floor Wash Nozzle

FS728 - with FS722 Adjustable
Wash Down Spray

Pictured with light duty, easy to use
FS731 trigger spray with "stay on" clasp.
Also available with a variety of attachments
including FS722 heavy duty trigger

TRIGGER SPRAY WITH FLOOR WASH NOZZLE

Order Code:

FS731



HEAVY DUTY ADJUSTABLE WASH DOWN SPRAY

Order Code:

FS722



HAND HELD TRIGGER SPRAY WITH SP325 FIXED SPRAY NOZZLE

Order Code:

FWS730DL - Trigger
Spray Only

FWS729D - 1m hose
and wall bracket

FWS730D - 1.5m hose
and wall bracket

FWS830D - 3m hose
and wall bracket



RELATED PRODUCTS

Lever Action Series - 150 and 200mm — Page 107
Lever Action Expo Series — Page 118

Electronic Touch Button and Sensor Tapware — Page 239
Knee Operated and Foot Operated Tapware — Page 159
Time Flow Tapware — Page 82

Pre-Rinse Assembly With Swivel Arm

FHA016

Standard

FHA116

With Pot Filler

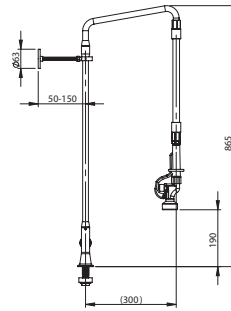
**Hob Mounted Riser Assembly**

FHS001

With Spring Return

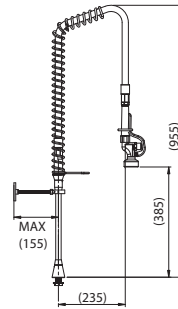
**Hob Mounted Pre-Rinse Unit with Single Control Assembly**

FHS011

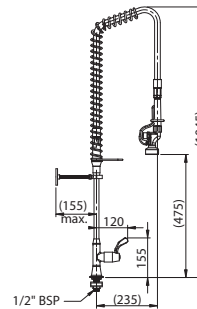
**Hob Mounted Pre-Rinse Unit with Concealed Mixer Assembly**

FHS021

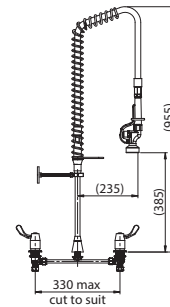
**Hob Mounted Pre-Rinse Unit with Exposed Mixer Assembly**

FHS031

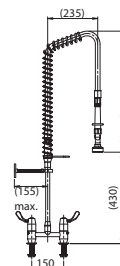
**Hob Mounted Pre-Rinse Unit with Dual Mixer Assembly**

FHS041

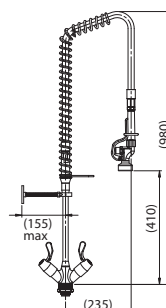

Hob Mounted Riser Assembly with Pot Filler

FHS101

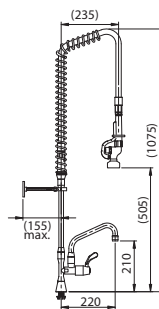

Hob Mounted Pre-Rinse Unit with Single Control Assembly with Pot Filler

FHS111

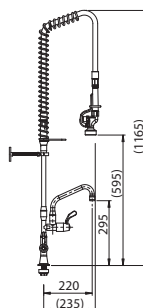

Hob Mounted Pre-Rinse Unit with Concealed Mixer Assembly with Pot Filler

FHS121

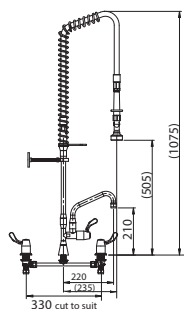

Hob Mounted Pre-Rinse Unit with Exposed Mixer Assembly with Pot Filler

FHS131

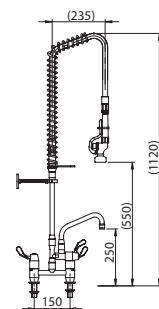

Hob Mounted Pre-Rinse Unit with Dual Mixer Assembly with Pot Filler

FHS141

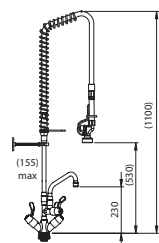

Hob Pre Rinse Assembly with Pot Filler

FS781

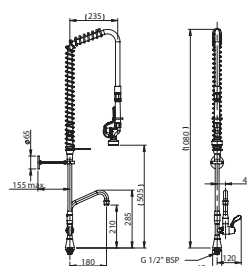

VP Dual Mixer with Diverter

VP370C

Jumper Valve Diverter with SP012 (Coles)

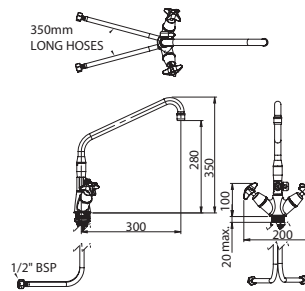
**Pot Filler & Riser**

FS760

Hob

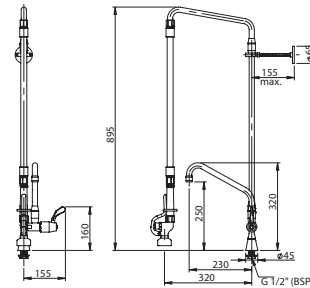
**Pre Rinse Wall Riser Assembly**

FWS001

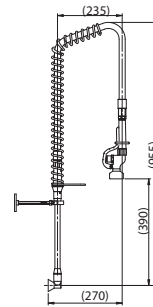
**Pre Rinse Wall Pre Mix Assembly**

FWS011

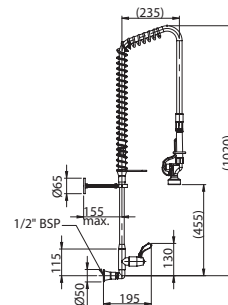
**Pre Rinse Wall Concealed Mixer Assembly**

FWS021

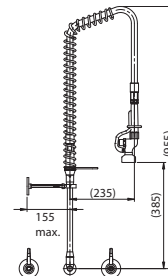
**Pre Rinse Wall Exposed Mixer Assembly**

FWS031

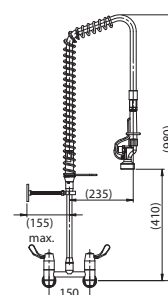

Pre Rinse Wall Riser Assembly With Pot Filler

FWS101

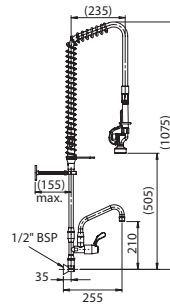

Pre Rinse Wall Pre Mix Assembly With Pot Filler

FWS111

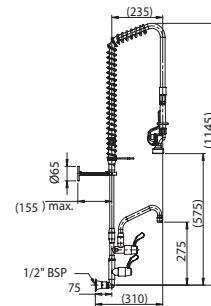

Pre Rinse Wall Concealed Mixer With Pot Filler

FWS121

Standard

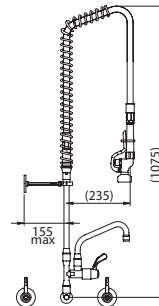

Pre-Rinse Wall Concealed Mixer Assembly With Pot Filler — Less Riser

FWS121C

Coles Pattern

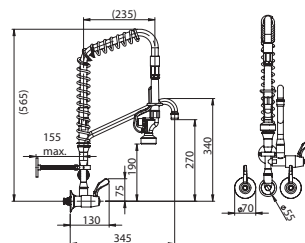

Pre Rinse Wall Concealed Mixer Assembly With Pot Filler — Less Riser

FWS121W

Woolworth's Pattern

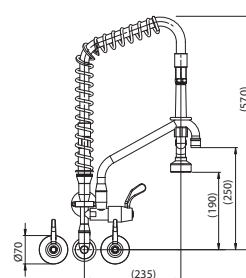

Pre Rinse Wall Exposed Mixer Assembly With Pot Filler

FWS131

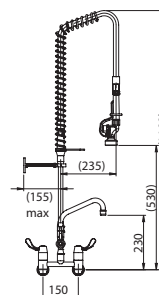

Mixing Set With Jumper Valve

FSJ705

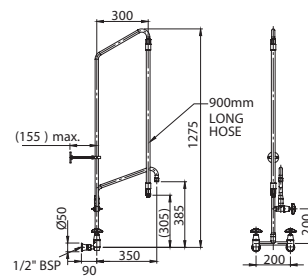
**Pre Rinse Wall Pre Mix Assembly**

FWA016

Single Control Assembly

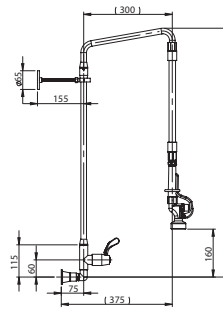
**Pre Rinse Wall Pre Mix Riser Assembly**

FWA056

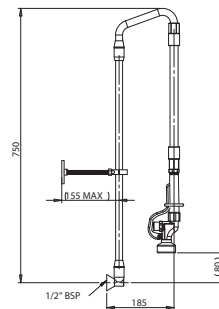
**Pre Rinse Wall Pre Mix Assembly With Pot Filler**

FWA116

Single Control Assembly

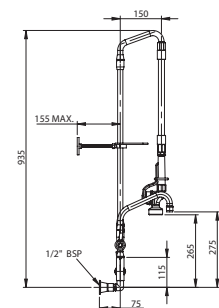
**Pre Rinse Wall Riser With Pot Filler**

FWA156

**Wall Exposed Jumper Valve Mixing Set With Pot Filler**

FS704

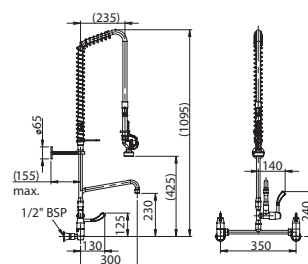

Mixing Set Complete

FS705

Type McDonalds

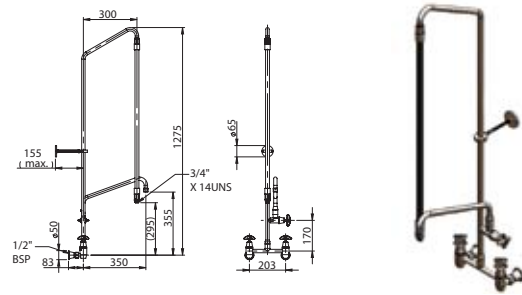

Ultra-Rinse Pre-Rinse Trigger Spray

FS729

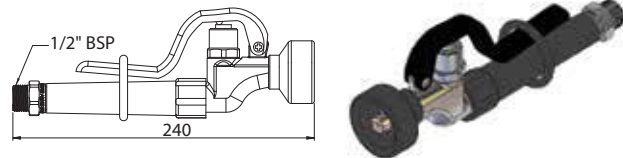

Ultra-Spray Soft Rinse Trigger Spray

FS729SS

Ultra Spray Soft Rinse Trigger Spray

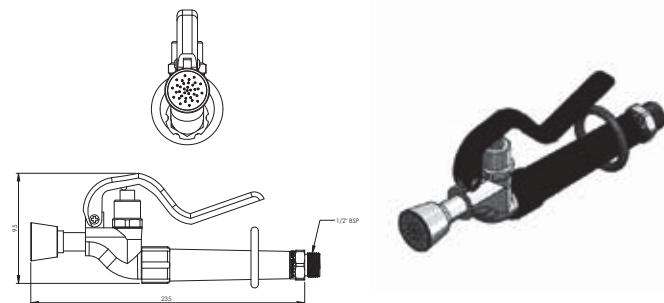

Trigger Spray Handle and Screw Replacement Part

FS790

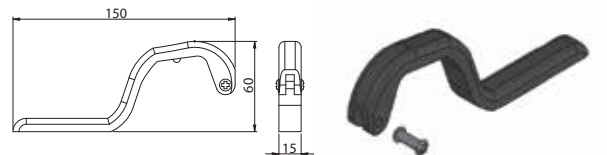

Ultra-Rinse Pre-Rinse Trigger Spray — Spare Parts

FS077

Old Style Service Kit — Suits FS721

FS077NS

Service Kit Suits FS729

FS721S

Stuffing Box Assembly — Suits FS721 and FS729

Hand Held Trigger Spray — Filler Design

FWS720

Water Filler Assembly — Aldi

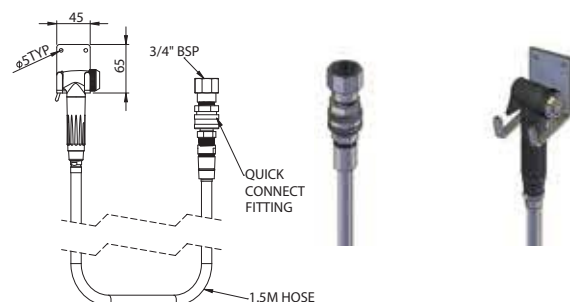

Adaptor Nuts

FS078	7/8m x 1/2F Chrome Plated
FS080	T&S Nut 7/8 x 20TPI x 15mm FI
FS081	T&S Nut 5/8 x 18UNF x 15mm FI
FS082	3/4 x 14 UNEF x 1/2 BSP FI
FS083	3/4 x 14 UNEF X x BSP FI

Hand Held Delrin Trigger Spray with SP325 Fixed Spray

FWS729D	1000mm Flexible Hose and Wall Bracket
FWS730D	1500mm Flexible Hose and Wall Bracket
FWS730DL	Trigger Spray Only

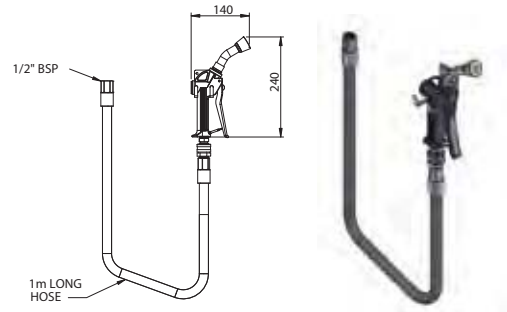
**Hand Held Trigger Spray with 3 metre Hose**

FWS830D	Trigger Spray with SP325 Fixed Spray
---------	--------------------------------------

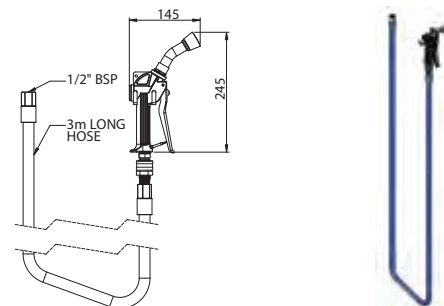
**Hot & Cold Wash Down Hose Reel with FS731 Delrin Trigger Spray**

FS724	Hose length: 12m; Inlet Hose Length: 1m
-------	---

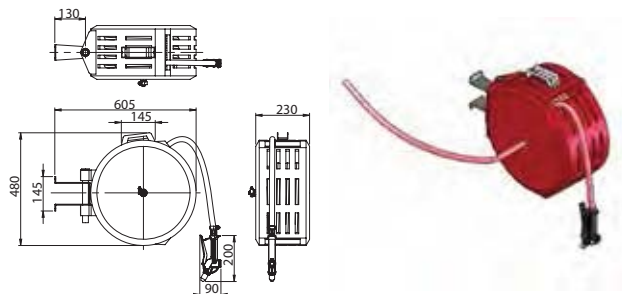
**Hot & Cold Wash Down Hose Reel with FS722 Adjustable Gunner Trigger Spray**

FS728	Hose length: 12m; Inlet Hose Length: 1m
-------	---

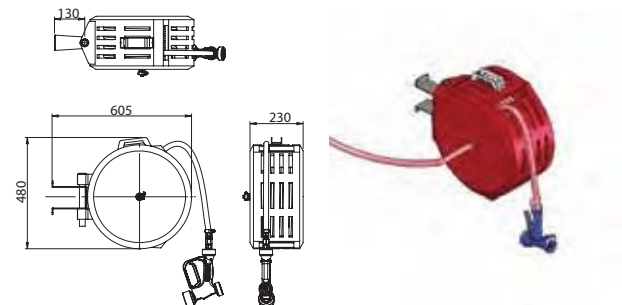
**Wash-down Adjustable Spray 15mm FI**

FS722

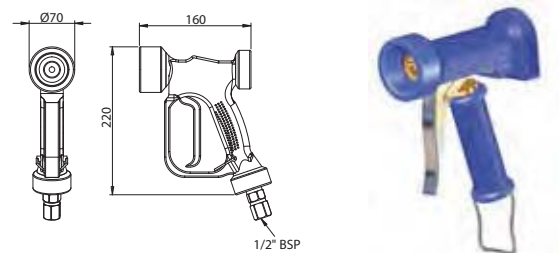

Delrin Trigger Spray with Floor Wash Nozzle

FS731

Floor Wash Outlet



Delrin Trigger Spray

FS730

1/2 Inch F&F for attachments

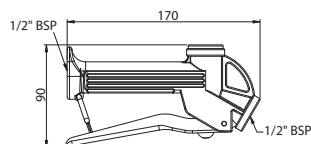

Hob Mounted Riser Base

FS010

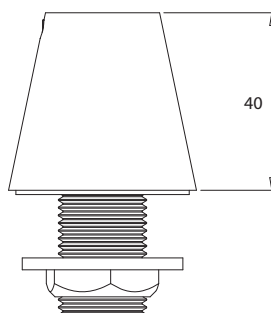

Pre-Mix Single Base — Hob Mounted

FS011

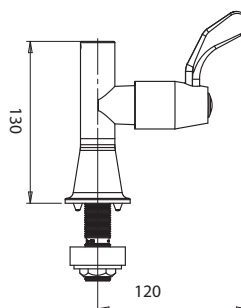

Hob Mounted Exposed Mixer Base

FS012

Exposed

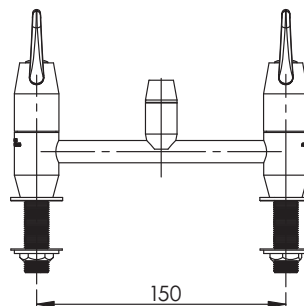

Hob Mounted Concealed Mixer Base

FS013

Concealed

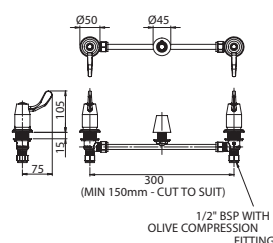

Hob Mounted Dual Mixer Base

FS015

Dual

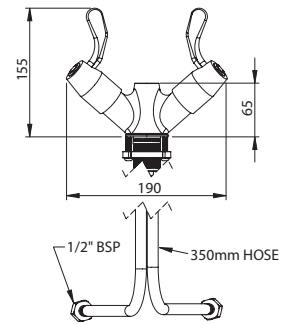
**Wall Mounted Riser Base**

FS020

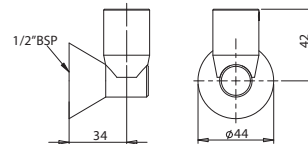
**Wall Mounted Pre-Mix Single Base**

FS021

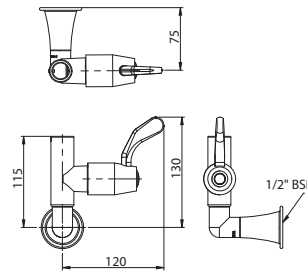
**Wall Mounted Exposed Mixer Base**

FS022

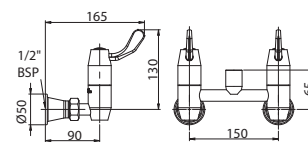
**Wall Mounted Concealed Mixer Base**

FS023

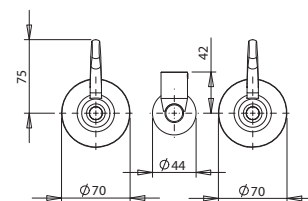
**Pot Filler Adaptor (excluding spout)**

FS063

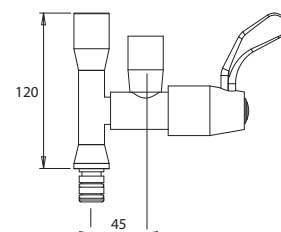

D

Standard Outlet Aerated

FS180	180mm reach x 65mm height to outlet
FS181	230mm reach x 105mm height to outlet
FS182	300mm reach x 125mm height to outlet

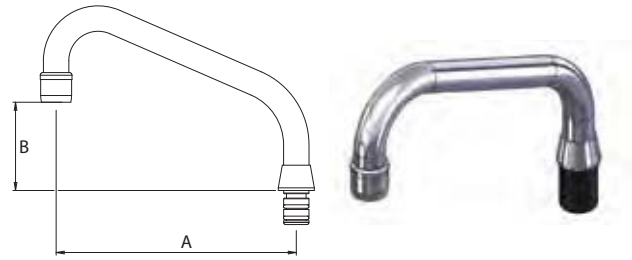

Curved Outlet Aerated

FS184	150mm reach x 95mm height to outlet
FS185	200mm reach x 135mm height to outlet

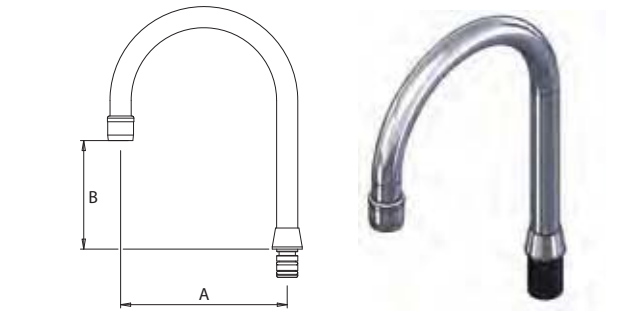

Swivel Spout — Reach 350mm (Type M)

FS708	Type McDonalds
-------	----------------

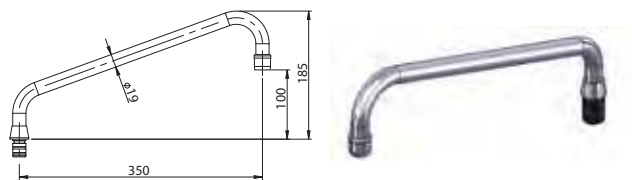

Riser

FS051	100mm
FS053	300mm
FS056	600mm
FS059	900mm

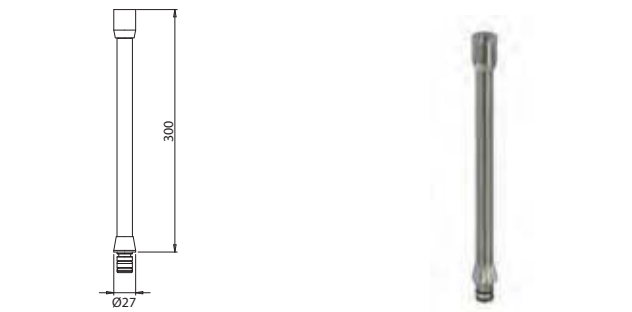

Spring Retainer Extension

FS061



Adjustable Wall Bracket

FS070	Standard
-------	----------

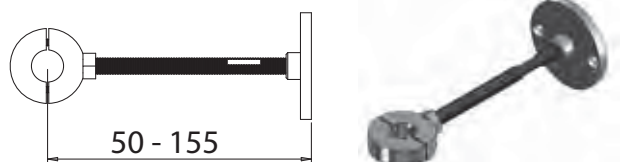

Trigger Spray Wall Bracket

FS071

**Trigger Spray Hook**

FS072

**Exterior Spring Guard**

FS100	585mm (Standard)
FS101	385mm (Non-Standard)

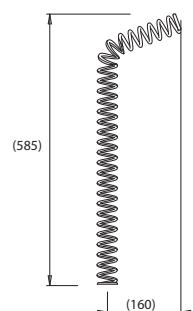
**Hose 15mm BSP FI**

FS104	400mm
FS106	600mm
FS109	900mm
FS110	1000mm (Standard)
FS111	1100mm
FS115	1500mm

**Heavy Duty Swivel Arm for Hose Connection**

FS187	300mm x 75mm height to outlet with 15 BSP
FS188	150mm x 55mm height to outlet with 15 BSP

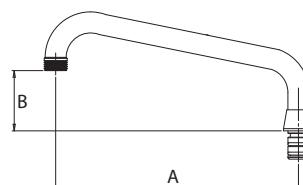
**900mm Mixing Set Hose (Type M)**

FS706	Type McDonalds
-------	----------------



Riser With Pot Filler Assembly (Type M)

FS707

Type McDonalds



Riser Assembly Food Service Mixer Conversion (Type M)

FS709

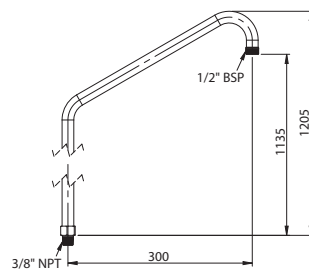

Expo Button

FS092

Hot

FS093

Cold

FS094

Plain



1/4 Turn Rising Jumper Valve Stuffing Box Assembly with Handle

FSJ095

Expo JHS Jumper Valve Pill/Bib SBA — Hot

FSJ096

Expo JHS Jumper Valve Pill/Bib SBA — Cold

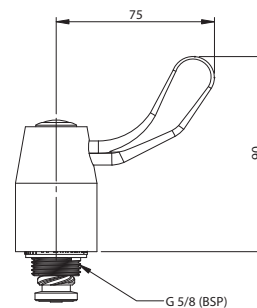

Food Service Recess Adaptor

FSJ308

1/4 Turn Rising Jumper Valve

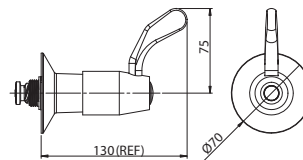

Food Service Lever Handle

FSJ378

For rising Jumper Valve SBA

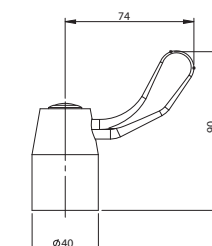

Food Service Top Assembly

FSJ390

Pillar/Bib Tap Top Assembly
— Specify Hot or Cold

FSJ391

Basin/Sink Top Assembly
— Specify Hot or Cold

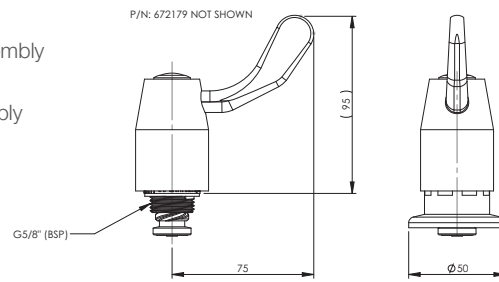
**1/4 Turn Rising Jumper Valve Recess SBA**

FSJ395

Cold

FSJ396

Hot

**1/4 Turn Rising Jumper Valve Stuffing Box Assembly**

FSJ381

SBA Suits all except recessed wall
(FWS021/FWS121) — Specify Hot or Cold

**1/4 Turn Non-Rising Jumper Valve Stuffing Box Assembly (OLD STYLE)**

FS095

Hot

FS096

Cold

**Quick Connection Coupling 1/2 Inch BSP Female**

FS733

Washer Service Kit plus O-Ring

FS734



Food Service Lever Sign Red Blue (PR)

MIS620



Diverter Retrofit Kit

FS064

(suits VP370C)

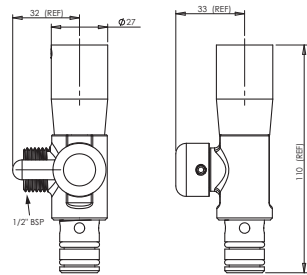

hands free foot & knee operated tapware

Knee operated tapware is available in the Spring Action self-closing valve or the Time Flow automatic shut-off valve.

Time Flow is available in various timing options with standard cycle times as specified.

Hands free foot operated tapware is a self-closing Spring Action mechanism.

The Enware Foot and Knee tapware range is constructed from dezincification resistant (DR) brass.

water efficiency



4 star (8lpm) rating supplied standard. Also available in 3 star (9.5lpm) and 5 star (6lpm) and 6 star (6lpm) ratings.

options

VALVING OPTIONS:

- Time Flow Self Closing Valve
- Spring Action Self Closing Valve

SPOUT OPTIONS:

- Enware offer a wide variety of spouts and shower roses – please refer our Outlets Section in this Product Guide — Page 208

technical information

	TIME FLOW	SPRING ACTION
Minimum–Maximum Working Pressure (AS/NZS 3500)*	50–500kPa 250–350kPa for optimum performance	50–500kPa
Maximum Working Temperature	50°C	80°C

*Tapware and showers must be installed in compliance with Australian National Plumbing Code and any local Standards. AS/NZS3500 states a maximum working pressure of 500kPa at any outlet.



WaterMark
AS/NZS 3718 WMKA 1583
SAI Global

Enware Tapware is manufactured to the exacting WaterMark standard AS/NZS3718 and AS4020.

RELATED PRODUCTS

Electronic Hands Free Tapware — Page 239

Automatic Shut-Off Spring Action and Time Flow Tapware — Page 63

Outlets and Spouts — Page 208

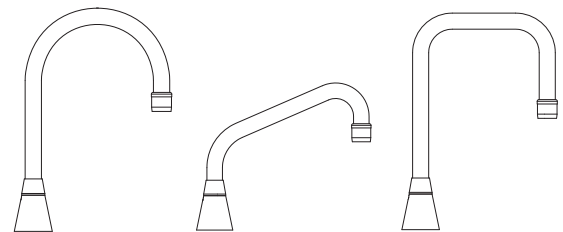

Enware-Delabie Knee Operated Lever Only 350mm

TFC796

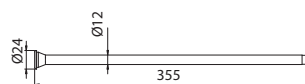

Foot Operated Top Assembly

BUB264

Spring Action

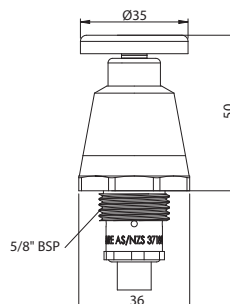

Foot Operated Stop Tap 90 Degree FI 15mm Loose Nut Connector

BUB265

Spring Action

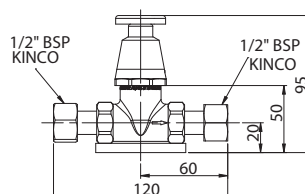

Foot Operated Stop Tap 45 Degree FI 15mm Loose Nut Connector

BUB266

Spring Action

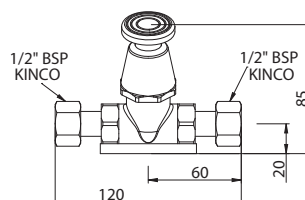

Foot Operated Stop Tap 90 Degree F&F 15mm

BUB268

Spring Action

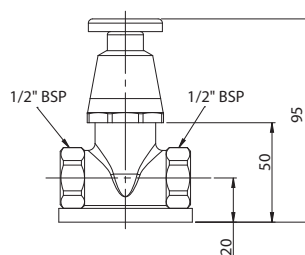

Knee Operated Spring Action Valve F&F 15mm

BUB268L

Straight Lever

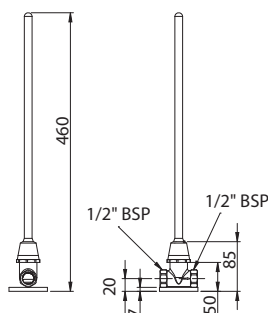

Knee Operated Spring Action Valve F&M 15mm

BUB268R

Right Angle

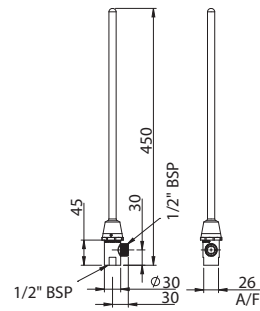
**Foot Operated Stop Tap 45 Degree F&F 15mm**

BUB269

Spring Action

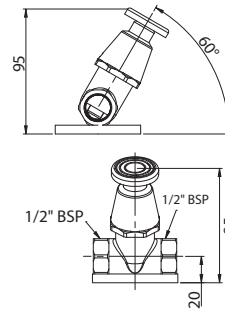
**Foot Operated Basin Kit**

HFS775

Spring Action

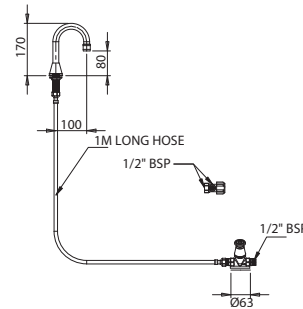
**Knee Operated Autotap Basin Kit**

HFS780

Time Flow — 15 Seconds

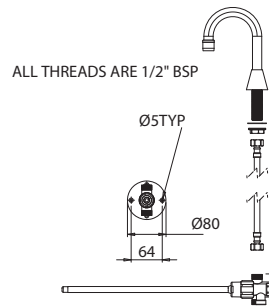
**Enware-Delabie Knee Operated Right Angle — Time Flow Valve**

TFC734

Time Flow — 15 Seconds

**Enware-Delabie Knee Operated Straight Time Flow Valve**

TFC735

Time Flow — 15 Seconds

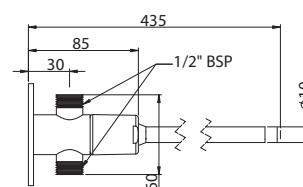

Spare Part — Knee Op Rod for BUB268L and BUB268R Models

BUB301

Enware-Delabie TempoStop Time Flow Cartridge Only Replacement suits Type TFC734/735/745L/746L (not button models)

TFC791

15 Seconds Cartridge Only (For 7 or 3 seconds request when ordering)



Enware-Delabie Pedal Valve Service Kit

TFC795

Suits TFC736 and TFC739



Enware-Delabie TempoStop Service Kit — Suits TFC734/735/745/746

TFC753005

7 Seconds

TFC797

15 Seconds

